

# Dream Tree DREAM PITCHER

## About Your Dream Pitcher...

The Dream Pitcher not only purifies your city tap water but adds hydrogen to remove free radicals, supplies minerals to create alkaline water that supports your metabolism, creates smaller water clusters that are more quickly absorbed, and improves taste—all in one easy step!

### Assembly

1. Remove the filter from its packaging and rinse well.
2. Soak the filter for 20 minutes.
3. Wash all the parts (pitcher, filter housing, and lid) thoroughly before first use.
4. Gently press the filter into the filter housing and ensure a secure fit.
5. Fill your filter with cold tap water (NEVER HOT) and enjoy.

### Precautions

1. Keep away from direct sunlight.
2. Only use approved water sources: city tap water.
3. Discard the very first TWO pitchers.
4. For quality assurance, DO NOT store your water for extended periods. Always consume your filtered water in a timely fashion.
5. If you don't use your pitcher for a few days, pour out any leftover water.
6. If you don't plan to use your pitcher for an extended period (vacation, etc.), store your filter in a plastic bag in the refrigerator.
7. After a long period of disuse, always soak your filter in water for 20 minutes before using again.

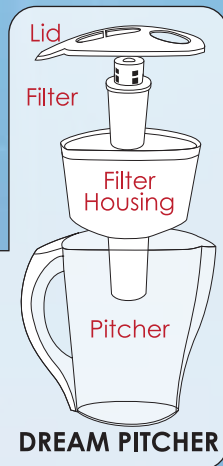
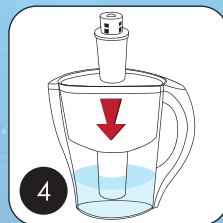
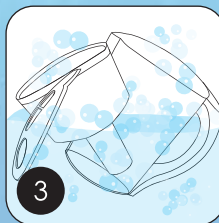
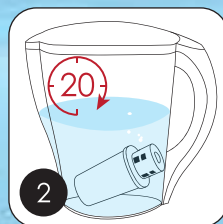
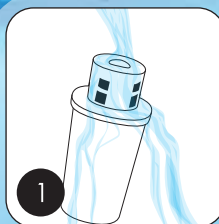

### What's In The Box? →

Filter Contains: SAN,  
Activated Carbon,  
Calcium Sulfite, Ion  
Exchange Fzesin